



深圳市宇能达科技有限公司

EAST(SHENZHEN)TECHNOLOGY CO.,LTD

碱锰扣式电池技术规格

TECHNICAL SPECIFICATION FOR
ALKALINE MANGANESE DIOXIDE BUTTON CELL

电池系列-4LR44 无汞电池

BATTERY SERIES-4LR44 0%Hg&Pb-Mercury Free

受控状况	
编写	
审核	

文件编号: EUNICELL-4LR44-2019D

版次: D

编写日期: 2019-03-18

电话 (TEL): 0755-86006961

传真 (FAX): 0755-86968868

网址 (NET): <http://www.eunicell.com>

(Information in the document is just for reference, not for gurantee of battery performance)

1.Other name for the same type

4LR44 L1325 4G13 4AG13 4A76

2.Chemical SystemAlkaline Zinc—Manganese battery (+) Zn | KOH | MnO₂ (-)**3.Nominal Voltage: 6.0V****4.Average Weight: 9.97g****5.Nominal Capacity: 160mAh**

(continuous discharge at 20±2°C under 0.22mA discharge current to 3.60V voltage)

6.Appearance: Metal Can**7.Electrical Characteristics:**

7.1 Off—load Voltage:

New Battery ≥ 6.05V

After 12 Months (Room Temp.) ≥ 6.00V

7.2 Discharge Time(continuous discharge at 20±2°C under 7.5KΩ discharge load to 3.60V voltage)

New Battery ≥ 190 hours

After 12 Months (Room Temp.) ≥ 170 hours

7.3 Over—discharge Characteristic

Condition: 7.5KΩ continuous discharge at 20±2°C & 65±20% R.H.

Period: 48hours

Characteristic: No deformation is over 0.20mm of the nominal dimension, and no visual electrolyte leakage

8. Dimensions:

Nominal Dimension: $\varnothing 13.00 \times 25.20$
 (Unit: mm)

Dimension	Range
A(ref.)	0.80
B	24.85 ± 0.25
C	12.70 ± 0.15
D(ref.)	0.20

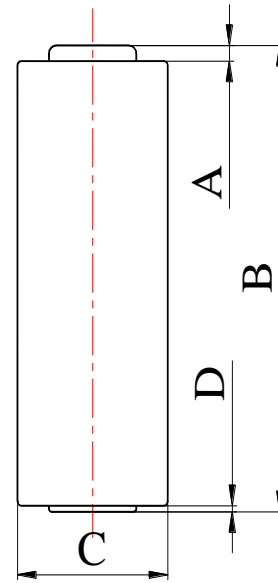

9. Typical Discharge Characteristics

(continuous discharge at $20 \pm 2^\circ\text{C}$ under $7.5\text{K}\Omega$ discharge load to 3.60V voltage)

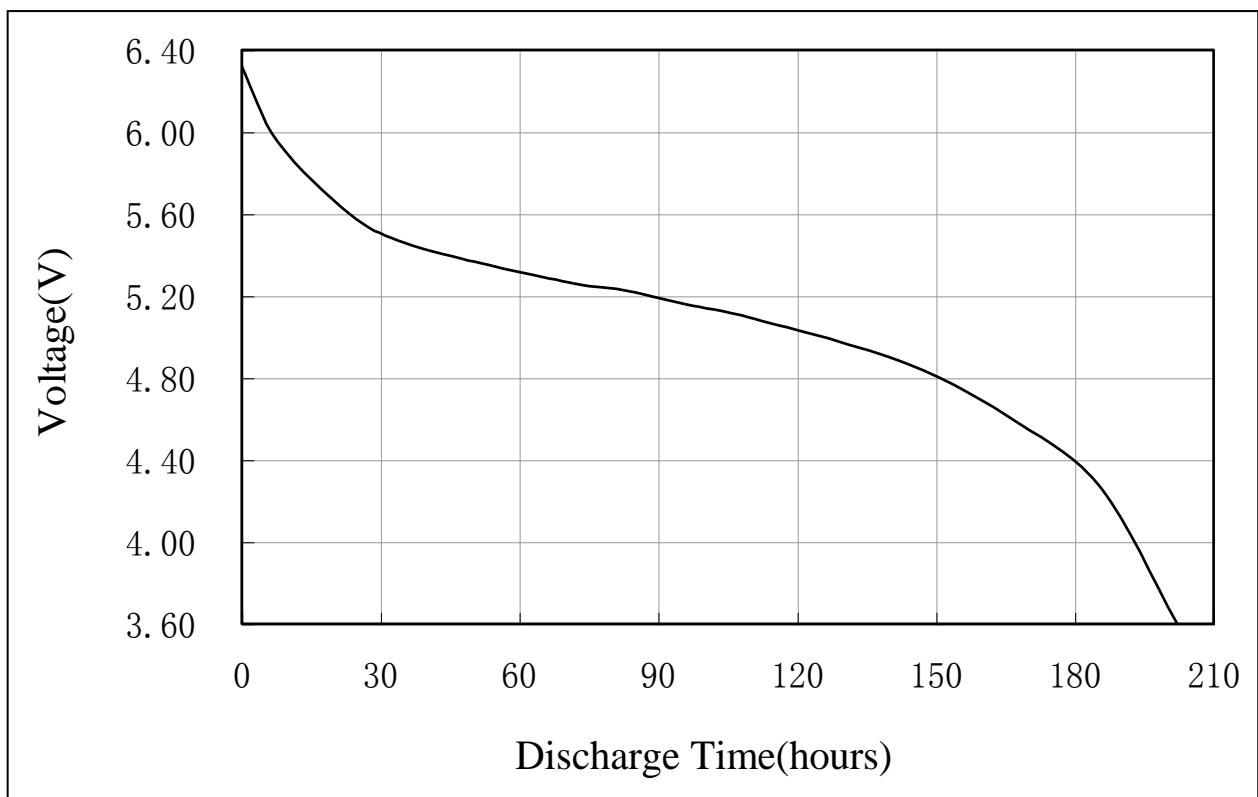

10. Mark:

The following message will be printed or stamped on the body of the battery:

10.1 Designation: **4LR44 L1325 4G13 4AG13 4A76** etc.

10.2 Manufacturer's name: East(Shenzhen) Technology Co., LTD.

10.3 Trademark: Eunicell .

10.4 Nominal Voltage: 6V.

10.5: Pole: “+” and “-”.

10.6 Warning: May explode or leak if charged or disposed of in fire.

11. Caution for use :

11.1 There are risks of electrolyte leakage or causing damage to the device if the battery is charged;

11.2 The battery shall be installed with “+”and “-” in correct position;

11.3 Short-circuiting and heating the battery、 disposing of the can must not be permitted.

—————END—————